

The 379i Series is a perfect fixture for industrial applications desiring a wet/damp fixture or an enclosed high bay fixture. The 379i is a glass fiber reinforced product with injection molded lens options for precise detail and strength. The lenses also have frosted ends, lineal prism sides with frosted or optically clear face. All hardware is stainless steel with tamper resistant latches. The gear tray hinges at both sides with tool-less latches for ease of accessibility and maintenance. The 379i series comes standard with the V-hook Mounting system with zinc plated Mounting straps. Ask us about our customized performance reflector option. Lamps not included.

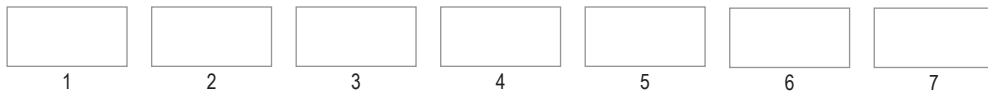

Additional Applications:

Machining Areas • Prep Areas • Tunnels • Wash Down Areas



1 SERIES	2 LAMP TYPE	3 LAMP QUANTITY	4 LENGTH	5 VOLTAGE
379i	T5: 28W T8: 32W* T8HO: 44W T5HO: 54W*	3L: 3 Lamp 4L: 4 Lamp* 5L: 5 Lamp 6L: 6 Lamp*	4: 4 Ft.	UNV1: 120-277V, 50/60Hz* 120: 120V, 60Hz 277: 277V, 60Hz UNV2: 347/480V, 50/60Hz - T5HO ONLY
6 LENS	7 OPTIONS		<p>Notes: * Standard fixture configurations Additional mounting configurations available consult factory. For chemical resistance information please see website.</p>	
Diffuser Type: A: Acrylic* P: Polycarbonate FA: Frosted Acrylic	HB: Enhanced Aluminum Reflector EM: Emergency Backup CM: Cable Mount (Cable not included) TR: Tamper Resistant Latches CR: Custom Performance Reflector System RZ: Rigid Ceiling Mount (zinc plated) RS: Rigid Ceiling Mount (stainless steel) MS: Mounting Strap (stainless steel) For use with cable or chain (not included) SL: Stainless Steel Latches			

LISTINGS

UL 1598 Wet / Damp
 CSA 22.2 No. 250.0
 NSF: Splash zone non-food prep
 NEMA 4X
 IP67 (enclosure only)
 High pressure tested 1500psi
 40°C ambient rating

FEATURES

5VA flammability rating
 Suitable for outdoor and Indoor use
 Closed cell polyurethane gasket with no seams
 Standard plastic (acetal copolymer) latches

CONSTRUCTION

Fiberglass White Housing
 Acrylic or Polycarbonate Lens

LENS

Impact resistant acrylic (91.5% transmission)
 Optional UV stabilized polycarbonate (87% transmission)
 Optically clear or frosted lens

ELECTRICAL

Available in 28, 32, 44, and 54 watts in T5, T8, T8HO, T5HO lamps.
 Voltages of 120, 277, 347 and 480.

OPTIONS

Enhanced aluminum reflector
 Emergency backup ballast
 Flexible ceiling mount kit
 Tamper resistant latches
 Custom performance reflector (special request)
 Stainless steel Mounting straps (same as standard except stainless steel)
 Rigid ceiling mount for surface Mounting or dual pendant (supplied by others)
 Stainless steel latches



379i

WET / DAMP LIGHTING

Food & Beverage Processing • Industrial • Pulp & Paper • Shipyards / Marine • Water Treatment



DIMENSIONS

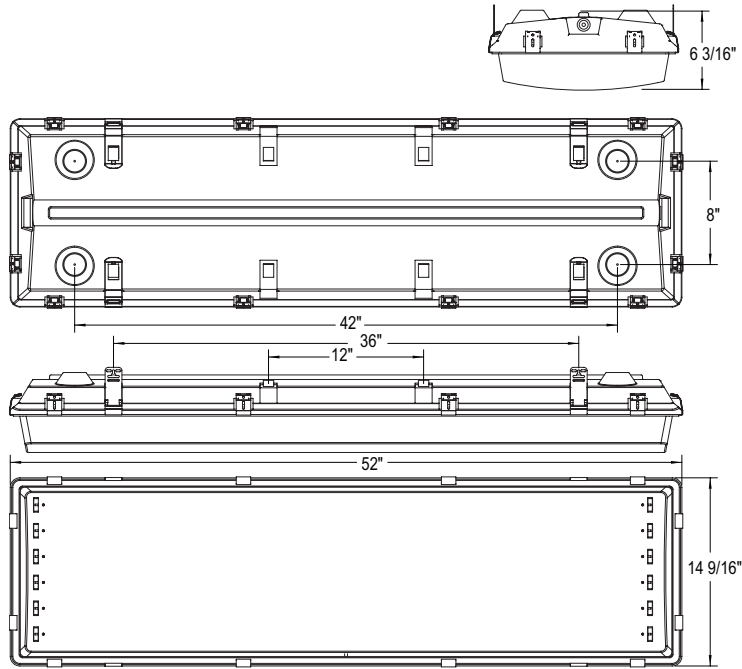

MOUNTING

Standard V-hook mounting with zinc plated mounting straps



316 Stainless Steel V-hook.
UL rated for 4X fixture weight.
Maximum fixture weight of 23lbs.

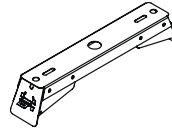

Rigid Ceiling Mount
RZ: Zinc plated
RS: Stainless steel

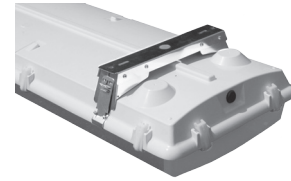

Flexible stainless steel ceiling mount system

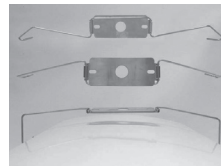

1 1/4" between ceiling and housing for heat dissipation Attaches directly to the ceiling!
Mounting holes on the 6986 ceiling mount kit are 1/4" X 1/2" oval with a measurement of 4" on center. Ceiling mount kit: 6986. Kit consists of (2) 6985 brackets.



RZ or RS also used for:
Dual Pendant Mounting
(Pendants supplied by others)

ADDITIONAL CEILING MOUNTS

Ceiling mount system kit: 8366:

Stainless steel ceiling Mounting brackets, sealing washer, 1/2" conduit hub, 1/2" conduit hub plug and stainless steel support plate. (Assembly required)

Ceiling mount system kit 8367 - Square bend U bolt

Ceiling mount system kit 8368 - U bolt

Ceiling mount system kit 8369 - 3 Ft. rod

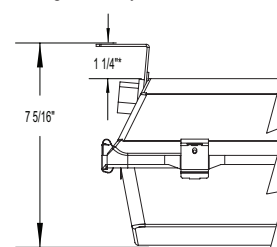
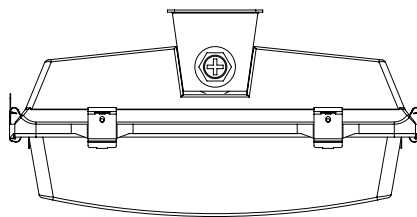
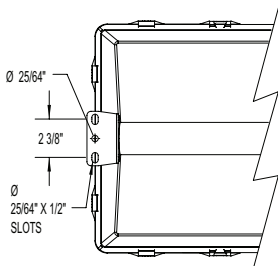

*BETWEEN CEILING AND HOUSING FOR HEAT DISSIPATION

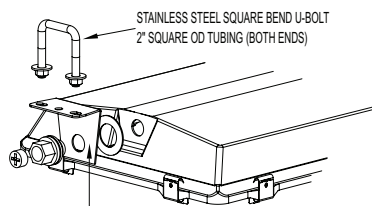

STAINLESS STEEL CEILING MOUNTING BRACKET (BOTH ENDS)

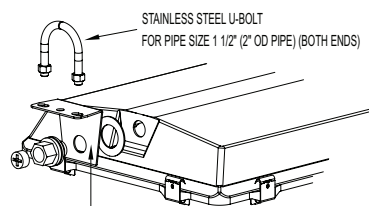

STAINLESS STEEL CEILING MOUNTING BRACKET (BOTH ENDS)

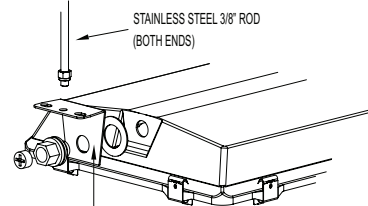

STAINLESS STEEL CEILING MOUNTING BRACKET (BOTH ENDS)